

## TECHNICAL DATA SHEET

# TUBE DIFFUSERS

page 1/2

PT70 X 500/750/1000, PT94 X 500/750/1000, 70MM AND 94MM TUBE

- Flooded support tube made of PVC head and environmentally-friendly polypropylene tube.
- Effective lengths: 500, 750 and 1000 mm
- Simple and fast installation
- Compatibility with other systems
- **Possibility for changing from existing DN 64 diffuser to DN 94 with higher efficiency and flow rate**

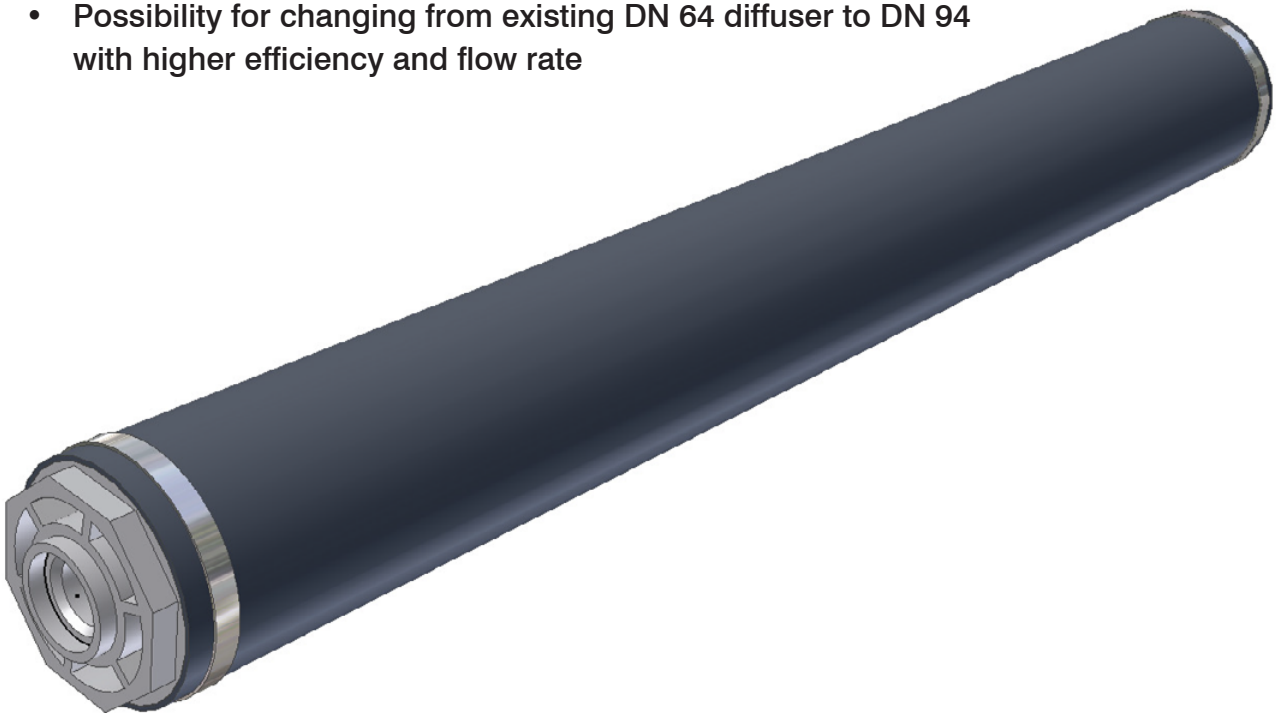

## MATERIALS

Stainless steel clamps, membranes in high quality EPDM and PU, body with PVC head with brass reinforced  $\frac{3}{4}$ " connection and tube in recyclable PP.

The PT tube diffuser offers a solid construction and impressive performance data. The common connections and optional adapters make it an extremely attractive product to retrofit quickly to out-dated and less efficient technologies.

## TECHNICAL DATA SHEET

# TUBE DIFFUSERS

page 2/2

PT70 X 500/750/1000, PT94 X 500/750/1000, 70MM AND 94MM TUBE

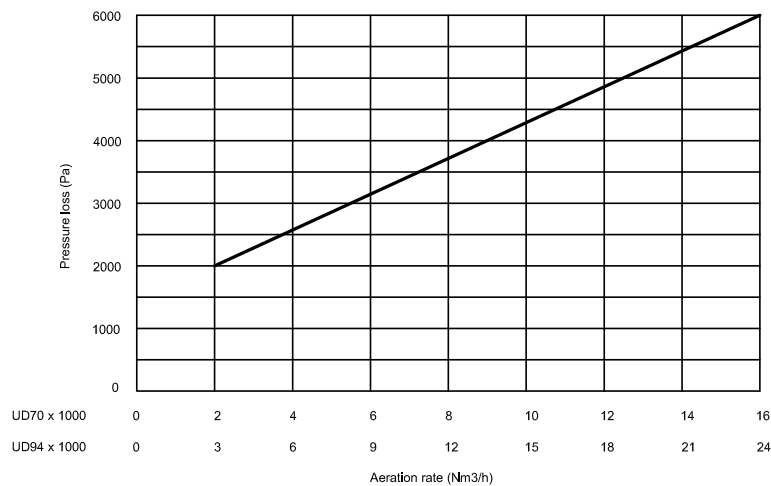
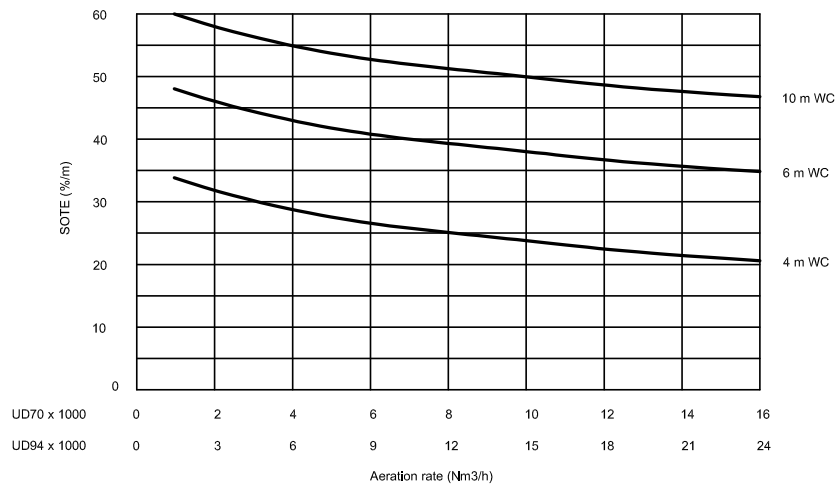
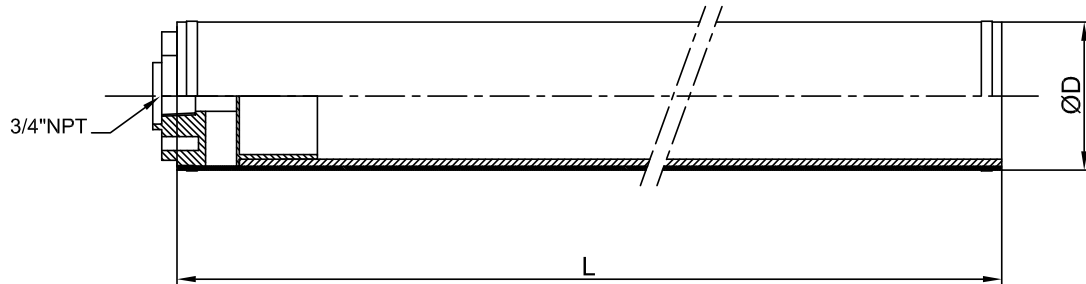

Type	Size (ØD)	Length (L)	Design Flow *	Flow Range *	Active Surface Area *	Weight (L=1000)
UD70	70 mm	500/750/1000 mm	2.6-14.5 Nm3/h	0-18 Nm3/h	0.15 m2	1.88 kg
UD94	94 mm	500/750/1000 mm	3.4-22.0 Nm3/h	0-27 Nm3/h	0.22 m2	2.54 kg

\* Data given pr. 1000 mm